

Proposed Access Details
- scale 1:250

Access Details

- Shared access detail for pair of dwellings as per DCAN 15.
- 6m clear opening provided between pillars with 5m set back from road edge.
- Access to provide 6m width for 10m depth from edge of carriageway.
- All pillars, walls & fences to be min of 450mm behind visibility splays.
- 2.4x90m visibility splays provided to non critical side.
- 2.4x70m visibility splay provided to critical side.
- Gullies to be provided to prevent rain water run off onto public road.
- First 5m of entrance section to have tarmac finish, transitioning to hardcore stone finish for length of laneway.
- Existing trees to upper side of teh road to be faced back to facilitate visibility splay.

2no. existing trees to be faced back along the existing fence line to facilitate visibility splays. No trees to be removed.

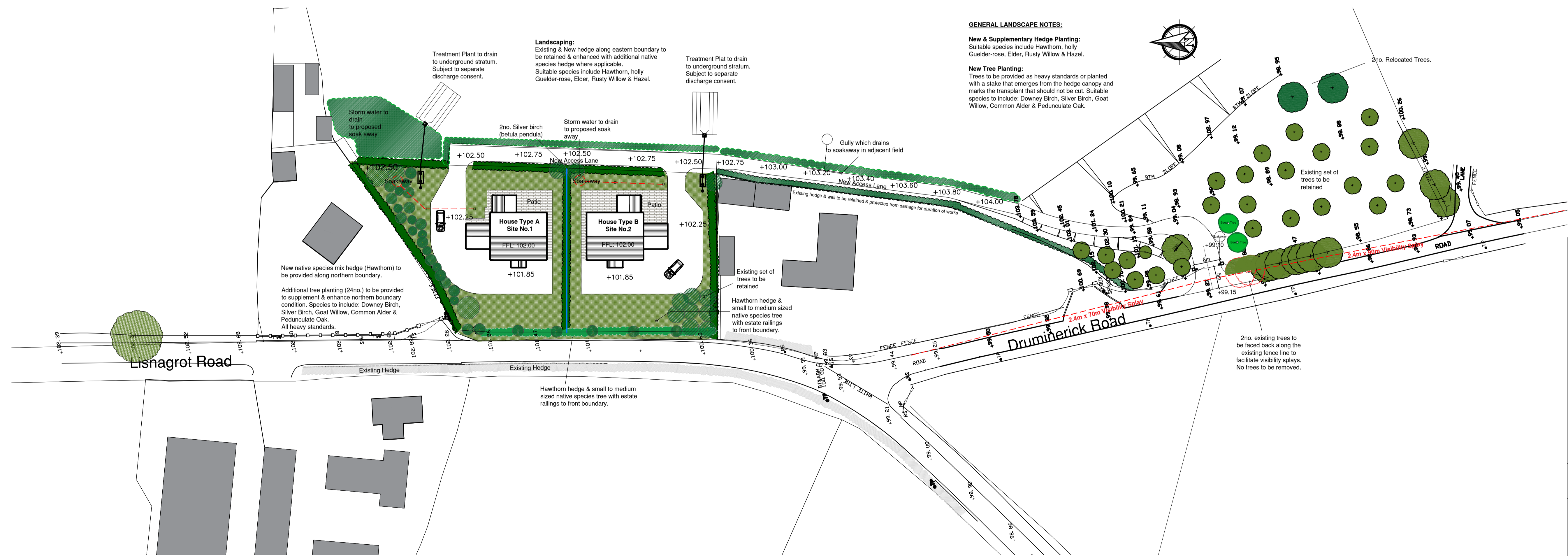

Proposed Site Plan
- scale 1:500

Client
MR BARNEY KIULT

Project Title
PROPOSED DWELLINGS
SOUTH OF
56 LISNAGROT ROAD
KILREA

Drawing Title
PROPOSED SITE PLAN
PROPOSED ACCESS DETAILS

Scale	Date	Dwg By
1:250 (A1)	20.09.2023	ND/KL

MANOR ARCHITECTS

Architecture / Planning / Conservation
Stable Buildings, Manor House, 30a High Street,
Moneymore, Co. L/derry, BT45 7PD
Telephone : 028 867 48367
Email: ma@manorarchitects.com
Web: www.manorarchitects.com

Drawing No.
19-31-PL-02 (k)